

**DIE SETS**

**MDL**



OCTOBER 2017



## STANDARD DIE SETS CONTENTS

■ Standard die sets with centre pillars .....	3
■ Standard die sets with rear pillars .....	4
■ Standard die sets with diagonal pillars .....	5
■ Rectangular die sets with centre pillars .....	6 - 7
■ Rectangular die sets with rear pillars .....	8 - 9
■ Rectangular die sets with diagonal pillars .....	10 - 11
■ Rectangular die sets with four pillars .....	12 - 13
■ Rectangular die sets with central pillars and ball bearing guide bushes .....	14 - 15
■ Rectangular die sets with rear pillars and ball bearing guides .....	16 - 17
■ Rectangular die sets with diagonal pillars and ball bearing guides .....	18 - 19
■ Rectangular die sets with four pillars and ball bearing guides .....	20 - 21

In order to provide a better response to your urgent ordering requirements, we can offer you three new die set solutions:

- Standard die sets: 48-hours delivery ex works (See pages 3 to 5).
- Rectangular die sets: 72-hours delivery ex works (See pages 6 to 21).
- Made-to-measure die sets: according to your plans and specifications
- Special die sets: according to individual design requirements

By matching bushes and pillars, we can offer you three adjustment categories:

**Category I :** For tooling processing of very thin sheet metal.  
For very fine clearance between punch and die sections.  
Where clearance per side is less than 0.02 mm.

**Category II :** For tooling processing of sheet metal more than 0.4 mm thick  
For clearance between punch and die sections from 0.02 to 0.06 mm per side.  
For most applications.

**Category III :** For clearance between punch and die sections of 0.08 mm per side.  
For automotive, forming dies.

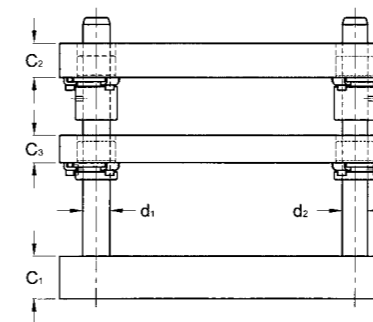

Standard die set with stripper plate Type D61.xxx.xxx

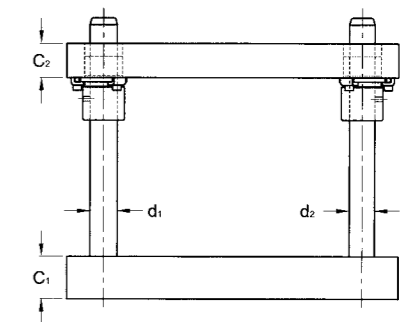

Standard die set Type D71.xxx.xxx

The plates are torch-cut and stress relieved.  
The guide elements can be chosen from our catalogue:

- Straight pillars P10.xxx.xxx
- Demountable pillars P2x.xxx.xxx
- Steel bushes B1x.xxx.xxx
- Bronze-plated bushes B2x.xxx.xxx

**Delivery: 48 hours ex works**

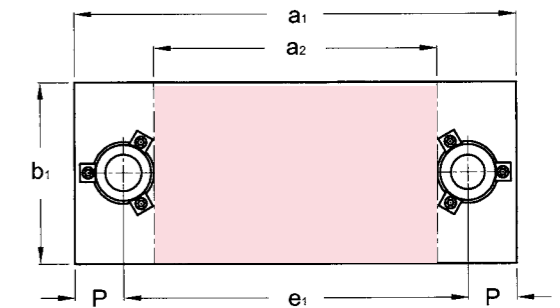

### Examples

Die set with stripper plate : D61.012.010  
Identical die set without stripper plate : D71.012.010

		Ext. dimensions			C <sub>1</sub> ±1	C <sub>2</sub> ±1	C <sub>3</sub> ±1	d <sub>1</sub> /L	d <sub>2</sub> /L	e <sub>1</sub>	P	Reference x = 6 : with C3 x = 7 : without C3									
a <sub>2</sub>	b <sub>1</sub>	a <sub>1</sub>	Work space																		
100	80		225	32	25	25	25/160	24/160	147	39	147	39	Dx1.010.008								
125		250	172											Dx1.012.008							
160		285	207												Dx1.016.008						
200		325	247													Dx1.020.008					
100	100	225	40	32	28	32/180	30/180	147	43	147	Dx1.010.010										
125		250										172	Dx1.012.010								
160		285										207		Dx1.016.010							
250		390										304			Dx1.025.010						
125	125	265	50	40	32	32/200	30/200	179	43	179	Dx1.012.012										
160		300										214	Dx1.016.012								
200		340										254		Dx1.020.012							
315		455										369			Dx1.031.012						
160	160	300	50	40	32	32/200	30/200	214	52	214	Dx1.016.016										
200		340										254	Dx1.020.016								
250		390										304		Dx1.025.016							
315		455										369			Dx1.031.016						
200	200	367	40/220	38/220	263	52	263	52	263	52	Dx1.020.020										
315		482										378	378			378	52	378	52	378	52
315		482										378		378							

L : Pin Length recommendations

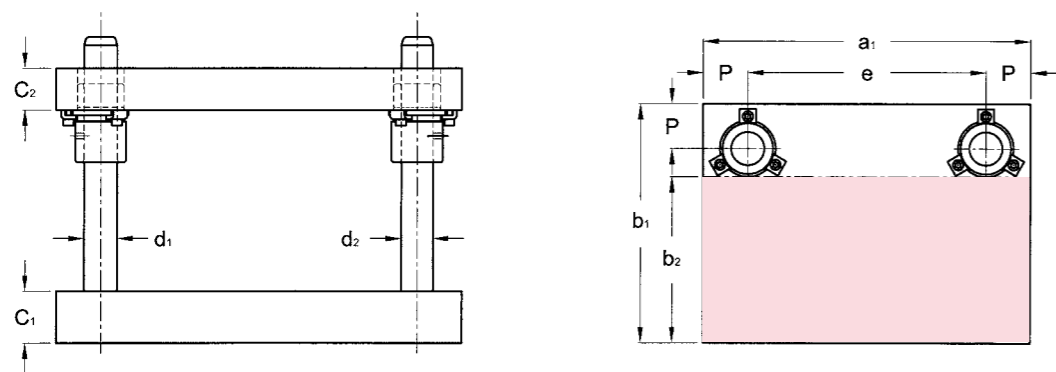

The plates are torch-cut and stress relieved.  
The guide elements can be chosen from our catalogue:

- Straight pillars P10.xxx.xxx
- Demountable pillars P2x.xxx.xxx
- Steel bushes B1x.xxx.xxx
- Bronze-plated bushes B2x.xxx.xxx

**Delivery: 48 hours ex works**

#### Example

Die set with rear pillars :

D72.031.010

Ext. dimensions			C <sub>1</sub> ±1	C <sub>2</sub> ±1	d <sub>1</sub> /L	e	P	Reference						
a <sub>1</sub>	b <sub>2</sub>	b <sub>1</sub>												
Work space			40	32	25/180	39	43							
125												69	28	D72.012.006
160	63	108							25	20	20/140	104	28	D72.016.006
200												144		D72.020.006
160												82		D72.016.008
200	80	143							32	25		122		D72.020.008
250												172		D72.025.008
200												122		D72.020.010
250	100	163										172		D72.025.010
315												237		D72.031.010
200						114		D72.020.012						
250	125	195				164		D72.025.012						
315						229		D72.031.012						
250						164		D72.025.016						
315	160	230	50	40	32/200	229		D72.031.016						
315	200	284	56	50	40/200	211	52	D72.031.020						

L : Pin Length recommendations

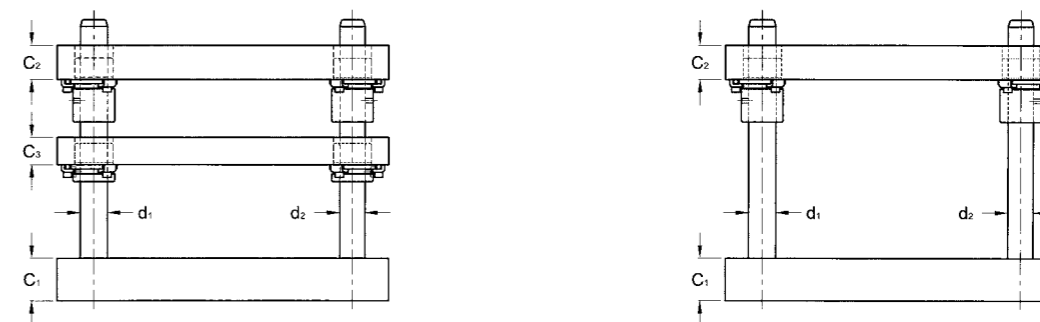

Standard die set with stripper plate  
type D63.xxx.xxx

Standard die set  
type D73.xxx.xxx

The plates are torch-cut and stress relieved.  
The guide elements can be chosen from our catalogue :

- Straight pillars P10.xxx.xxx
- Demountable pillars P2x.xxx.xxx
- Steel bushes B1x.xxx.xxx
- Bronze-plated bushes B2x.xxx.xxx

**Delivery: 48 hours ex works**

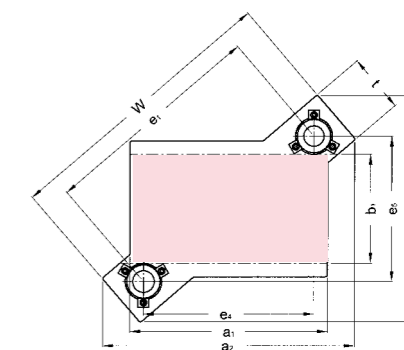

#### Examples

Die set with stripper plate :

D63.024.012

Identical die set without stripper plate :

D73.024.012

a <sub>1</sub>	b <sub>1</sub>	Ext. dimensions		C <sub>1</sub> ±1	C <sub>2</sub> ±1	C <sub>3</sub> ±1	d <sub>1</sub> /L	d <sub>2</sub> /L	e <sub>1</sub>	e <sub>5</sub>	e <sub>4</sub>	t	w	Reference x = 6 : with C3 x = 7 : without C3												
		a <sub>2</sub>	b <sub>2</sub>																							
Work space		260	300	40	32	28	25/180	24/180	193	147	125	78	271	Dx3.016.010												
165															235		32	25	25			218	160		296	Dx3.020.010
200	100														271						249	200		327	Dx3.024.010	
240															310						290	250		368	Dx3.029.010	
290															357											
200															282						240	160		326	Dx3.020.012	
240	125														322						269	200		355	Dx3.024.012	
290															371						308	250		394	Dx3.029.012	
355															433					32/200	30/200	363	315	86	449	Dx3.035.012
240															322						293	200		379	Dx3.024.016	
290	160	372	335	50	40	32		329	214	250		415	Dx3.029.016													
355		435						381	315			467	Dx3.035.016													
290		398						363	250			467	Dx3.029.020													
355	200	462	410				40/220	38/220	411	263	315	104	515	Dx3.035.020												
355	250	462	460						444	313	315		548	Dx3.035.025												

L : Pin Length recommendations

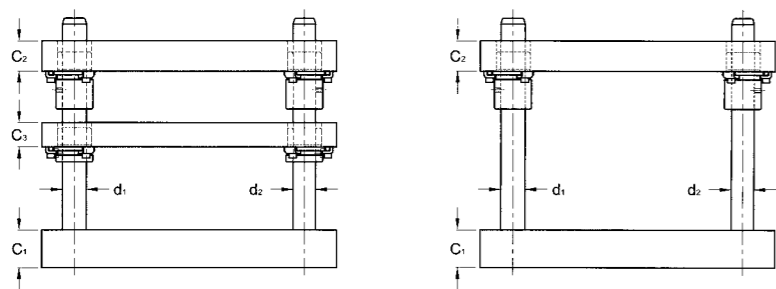

Standard assembly of bushes on underside of stripper plate.

Ext. dimensions			C <sub>1</sub> ±1	C <sub>2</sub> ±1	C <sub>3</sub> ±1	d <sub>1</sub> /L	d <sub>2</sub> /L	e	P	reference x = 8 : with C3 x = 9 : without C3										
a <sub>1</sub>	b <sub>1</sub>	a <sub>2</sub>																		
250	160	127	32	32	32	25/200	24/200	174	38	Dx1.125.016										
			32	40						Dx1.225.016										
			40	32						Dx1.325.016										
			40	40						Dx1.425.016										
	200		32	32						32	25/200	24/200	174	38	Dx1.125.020					
			32	40											Dx1.225.020					
			40	32											Dx1.325.020					
			40	40											Dx1.425.020					
	250		32	32											32	25/200	24/200	174	38	Dx1.125.025
			32	40																Dx1.225.025
			40	32																Dx1.325.025
			40	40																Dx1.425.025
315	200	171	32	32	32	32/200	30/200	225	45											Dx1.131.020
			32	40																Dx1.231.020
			40	32																Dx1.331.020
			40	40																Dx1.431.020
	250		32	32						32	32/200	30/200	225	45						Dx1.131.025
			32	40																Dx1.231.025
			40	32																Dx1.331.025
			40	40																Dx1.431.025
	315		40	32											32	32/200	30/200	225	45	Dx1.131.031
			40	40																Dx1.231.031
			50	40																Dx1.331.031
			50	50																Dx1.431.031
400	200	256	40	40	32	32/220	30/220	310	45											Dx1.140.020
			40	50																Dx1.240.020
			50	40																Dx1.340.020
			50	50																Dx1.440.020
	250		40	40						32	32/220	30/220	310	45						Dx1.140.025
			40	50																Dx1.240.025
			50	40																Dx1.340.025
			50	50																Dx1.440.025
	315		40	40											32	32/220	30/220	310	45	Dx1.140.031
			40	50																Dx1.240.031
			50	40																Dx1.340.031
			50	50																Dx1.440.031
400	40	40	32	32/220	30/220	310	45	Dx1.140.040												
	40	50						Dx1.240.040												
	50	40						Dx1.340.040												
	50	50						Dx1.440.040												

L : Pin Length recommendations

The plates are torch-cut and stress relieved.  
The steel or bronze-plated steel guide elements can be chosen from our "Guide Elements" catalogue.

Delivery: 72 hours ex works

### Examples

Die set with stripper plate : D81.463.040  
Identical die set without stripper plate : D91.463.040

a <sub>1</sub>	Ext. dimensions		C <sub>1</sub> ±1	C <sub>2</sub> ±1	C <sub>3</sub> ±1	d <sub>1</sub> /L	d <sub>2</sub> /L	e	P	Reference x = 8 : with C3 x = 9 : without C3										
	b <sub>1</sub>	a <sub>2</sub>																		
500	250	337	40	40	32	40/220	38/220	400	50	Dx1.150.025										
			40	50						Dx1.250.025										
			50	40						Dx1.350.025										
			50	50						Dx1.450.025										
	315		40	40						32	40/220	38/220	400	50	Dx1.150.031					
			40	50											Dx1.250.031					
			50	40											Dx1.350.031					
			50	50											Dx1.450.031					
	400		40	40											32	40/220	38/220	400	50	Dx1.150.040
			40	50																Dx1.250.040
			50	40																Dx1.350.040
			50	50																Dx1.450.040
500	40	40	32	40/220	38/220	400	50	Dx1.150.050												
	40	50						Dx1.250.050												
	50	40						Dx1.350.050												
	50	50						Dx1.450.050												
630	315	435						50	50	40	50/220	48/220	510	60						Dx1.163.031
								50	58											Dx1.263.031
								58	50											Dx1.363.031
								58	58											Dx1.463.031
	400							50	50						40	50/220	48/220	510	60	Dx1.163.040
								50	58											Dx1.263.040
								58	50											Dx1.363.040
								58	58											Dx1.463.040
	500		50	50	40	50/220	48/220	510	60											Dx1.163.050
			50	58																Dx1.263.050
			58	50																Dx1.363.050
			58	58																Dx1.463.050
630	50	50	40	50/220						48/220	510	60	Dx1.163.063							
	50	58											Dx1.263.063							
	58	50											Dx1.363.063							
	58	58											Dx1.463.063							
710	400	515											58	58	40	50/250	48/250	590	60	Dx1.171.040
													58	63						Dx1.271.040
													63	58						Dx1.371.040
													63	63						Dx1.471.040
	500				58	58	40	50/250	48/250				590	60						Dx1.171.050
					58	63														Dx1.271.050
					63	58														Dx1.371.050
					63	63														Dx1.471.050
	630		58	58	40	50/250				48/250	590	60								Dx1.171.063
			58	63																Dx1.271.063
			63	58																Dx1.371.063
			63	63																Dx1.471.063

L : Pin Length recommendations

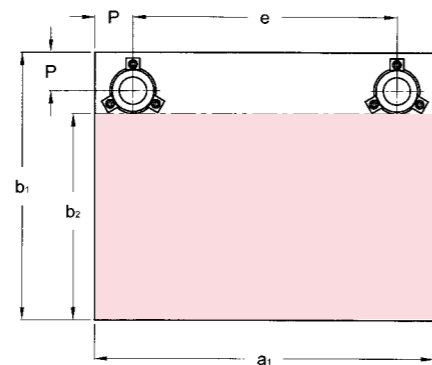
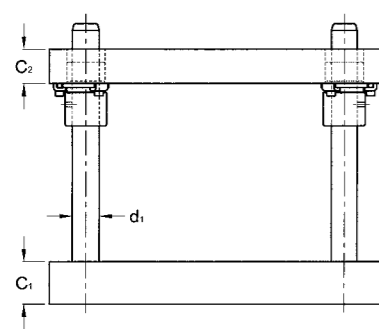

Ext. dimensions			C <sub>1</sub> ±1	C <sub>2</sub> ±1	d <sub>1</sub> /L	e	P	Reference
a <sub>1</sub>	b <sub>2</sub>	b <sub>1</sub>						
Work space								
250	98	160	32	32	25/200	174	38	D92.125.016
			32	40				D92.225.016
			40	32				D92.325.016
			40	40				D92.425.016
	138	200	32	32				D92.125.020
			32	40				D92.225.020
			40	32				D92.325.020
			40	40				D92.425.020
	188	250	32	32				D92.125.025
			32	40				D92.225.025
			40	32				D92.325.025
			40	40				D92.425.025
315	128	200	32	32	32/200	225	45	D92.131.020
			32	40				D92.231.020
			40	32				D92.331.020
			40	40				D92.431.020
	178	250	32	32				D92.131.025
			32	40				D92.231.025
			40	32				D92.331.025
			40	40				D92.431.025
	243	315	40	40				D92.131.031
			40	50				D92.231.031
			50	40				D92.331.031
			50	50				D92.431.031
400	128	200	40	40	32/220	310	45	D92.140.020
			40	50				D92.240.020
			50	40				D92.340.020
			50	50				D92.440.020
	178	250	40	40				D92.140.025
			40	50				D92.240.025
			50	40				D92.340.025
			50	50				D92.440.025
	243	315	40	40				D92.140.031
			40	50				D92.240.031
			50	40				D92.340.031
			50	50				D92.440.031
318	400	40	40	D92.140.040				
		40	50	D92.240.040				
		50	40	D92.340.040				
		50	50	D92.440.040				

L : Pin Length recommendations

The plates are torch-cut and stress relieved.  
The steel or bronze-plated steel guide elements can be chosen from our "Guide Elements" catalogue.

Delivery: 72 hours ex works

Example Rectangular die set with rear pillars: D92.450.050

Ext. dimensions			C <sub>1</sub> ±1	C <sub>2</sub> ±1	d <sub>1</sub> /L	e	P	Reference
a <sub>1</sub>	b <sub>2</sub>	b <sub>1</sub>						
Work space								
500	168	250	40	40	40/220	400	50	D92.150.025
			40	50				D92.250.025
			50	40				D92.350.025
			50	50				D92.450.025
	233	315	40	40				D92.150.031
			40	50				D92.250.031
			50	40				D92.350.031
			50	50				D92.450.031
	318	400	40	40				D92.150.040
			40	50				D92.250.040
			50	40				D92.350.040
			50	50				D92.450.040
418	500	40	40	D92.150.050				
		40	50	D92.250.050				
		50	40	D92.350.050				
		50	50	D92.450.050				
630	217	315	50	50	50/220	510	60	D92.163.031
			50	58				D92.263.031
			58	50				D92.363.031
			58	58				D92.463.031
	302	400	50	50				D92.163.040
			50	58				D92.263.040
			58	50				D92.363.040
			58	58				D92.463.040
	402	500	50	50				D92.163.050
			50	58				D92.263.050
			58	50				D92.363.050
			58	58				D92.463.050
532	630	50	50	D92.163.063				
		50	58	D92.263.063				
		58	50	D92.363.063				
		58	58	D92.463.063				
710	302	400	58	58	50/250	590	60	D92.171.040
			58	63				D92.271.040
			63	58				D92.371.040
			63	63				D92.471.040
	402	500	58	58				D92.171.050
			58	63				D92.271.050
			63	58				D92.371.050
			63	63				D92.471.050
	532	630	58	58				D92.171.063
			58	63				D92.271.063
			63	58				D92.371.063
			63	63				D92.471.063

L : Pin Length recommendations

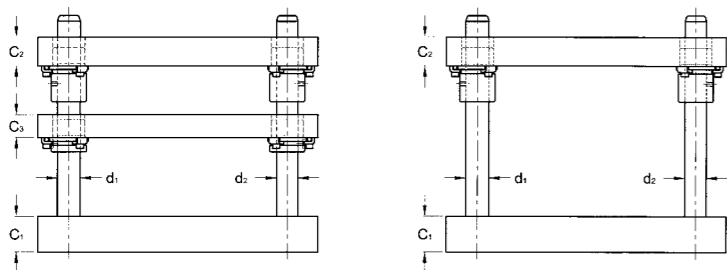

Standard assembly of bushes on underside of stripper plate.

Ext. dimensions				C <sub>1</sub> ±1	C <sub>2</sub> ±1	C <sub>3</sub> ±1	d <sub>1</sub> /L	d <sub>2</sub> /L	e <sub>1</sub>	e <sub>2</sub>	P	Reference x = 8 : with C3 x = 9 : without C3
Work space, direction A		Work space, direction B										
a <sub>1</sub>	b <sub>2</sub>	b <sub>1</sub>	a <sub>2</sub>									
250	37	160	127	32	32	32	25/200	24/200	174	84	38	Dx3.125.016
				32	40							Dx3.225.016
				40	32							Dx3.325.016
				40	40							Dx3.425.016
	77	200	127	32	32					Dx3.125.020		
				32	40					Dx3.225.020		
				40	32					Dx3.325.020		
				40	40					Dx3.425.020		
	127	250	127	32	32					Dx3.125.025		
				32	40					Dx3.225.025		
				40	32					Dx3.325.025		
				40	40					Dx3.425.025		
315	56	200	171	32	32	32	32/200	30/200	225	110	45	Dx3.131.020
				32	40							Dx3.231.020
				40	32							Dx3.331.020
				40	40							Dx3.431.020
	106	250		32	32					Dx3.131.025		
				32	40					Dx3.231.025		
				40	32					Dx3.331.025		
				40	40					Dx3.431.025		
	171	315		40	40					Dx3.131.031		
				40	50					Dx3.231.031		
				50	40					Dx3.331.031		
				50	50					Dx3.431.031		
400	56	200	256	40	40	32	32/220	30/220	310	110	45	Dx3.140.020
				40	50							Dx3.240.020
				50	40							Dx3.340.020
				50	50							Dx3.440.020
	106	250		40	40					Dx3.140.025		
				40	50					Dx3.240.025		
				50	40					Dx3.340.025		
				50	50					Dx3.440.025		
	171	315		40	40					Dx3.140.031		
				40	50					Dx3.240.031		
				50	40					Dx3.340.031		
				50	50					Dx3.440.031		
256	400	40	40	Dx3.140.040								
		40	50	Dx3.240.040								
		50	40	Dx3.340.040								
		50	50	Dx3.440.040								

L : Pin Length recommendations

The plates are torch-cut and stress relieved.  
The steel or bronze-plated steel guide elements can be chosen from our "Guide Elements" catalogue.

Delivery : 72 hours ex works

### Examples

Die set with stripper plate : D83.450.031  
Identical die set without stripper plate : D93.450.031

Ext. dimensions				C <sub>1</sub> ±1	C <sub>2</sub> ±1	C <sub>3</sub> ±1	d <sub>1</sub> /L	d <sub>2</sub> /L	e <sub>1</sub>	e <sub>2</sub>	P	Références x = 8 : with C3 x = 9 : without C3
Work space, direction A		Work space, direction B										
a <sub>1</sub>	b <sub>2</sub>	b <sub>1</sub>	a <sub>2</sub>									
500	87	250	337	40	40	32	40/220	38/220	400	150	50	Dx3.150.025
				40	50							Dx3.250.025
				50	40							Dx3.350.025
				50	50							Dx3.450.025
	152	315		40	40					Dx3.150.031		
				40	50					Dx3.250.031		
				50	40					Dx3.350.031		
				50	50					Dx3.450.031		
	237	400		40	40					Dx3.150.040		
				40	50					Dx3.250.040		
				50	40					Dx3.350.040		
				50	50					Dx3.450.040		
337	500	40	40	Dx3.150.050								
		40	50	Dx3.250.050								
		50	40	Dx3.350.050								
		50	50	Dx3.450.050								
630	120	315	435	50	50	40	50/220	48/220	510	195	60	Dx3.163.031
				50	58							Dx3.263.031
				58	50							Dx3.363.031
				58	58							Dx3.463.031
	205	400		50	50					Dx3.163.040		
				50	58					Dx3.263.040		
				58	50					Dx3.363.040		
				58	58					Dx3.463.040		
	305	500		50	50					Dx3.163.050		
				50	58					Dx3.263.050		
				58	50					Dx3.363.050		
				58	58					Dx3.463.050		
435	630	50	50	Dx3.163.063								
		50	58	Dx3.263.063								
		58	50	Dx3.363.063								
		58	58	Dx3.463.063								
710	205	400	515	58	58	40	50/250	48/250	590	280	60	Dx3.171.040
				58	63							Dx3.271.040
				63	58							Dx3.371.040
				63	63							Dx3.471.040
	305	500		58	58					Dx3.171.050		
				58	63					Dx3.271.050		
				63	58					Dx3.371.050		
				63	63					Dx3.471.050		
	435	630		58	58					Dx3.171.063		
				58	63					Dx3.271.063		
				63	58					Dx3.371.063		
				63	63					Dx3.471.063		

L : Pin Length recommendations

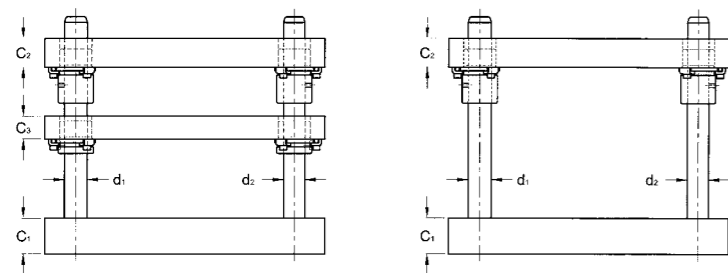

Standard assembly of bushes on underside of stripper plate.

Ext. dimensions				C <sub>1</sub> ±1	C <sub>2</sub> ±1	C <sub>3</sub> ±1	d <sub>1</sub> /L	e <sub>1</sub>	e <sub>2</sub>	P	References x = 8 : with C3 x = 9 : without C3
Work space, direction A		Work space, direction B									
a <sub>1</sub>	b <sub>2</sub>	b <sub>1</sub>	a <sub>2</sub>								
250	37	160	127	32	32	32	25/200	174	84	38	Dx4.125.016
				32	40						Dx4.225.016
				40	32						Dx4.325.016
				40	40						Dx4.425.016
	77	200	127	32	32				Dx4.125.020		
				32	40				Dx4.225.020		
				40	32				Dx4.325.020		
				40	40				Dx4.425.020		
				32	32				Dx4.125.025		
				32	40				Dx4.225.025		
				40	32				Dx4.325.025		
				40	40				Dx4.425.025		
315	77	200	192	32	32	Dx4.131.020					
				32	40	Dx4.231.020					
				40	32	Dx4.331.020					
				40	40	Dx4.431.020					
	127	250	127	32	32	Dx4.131.025					
				32	40	Dx4.231.025					
				40	32	Dx4.331.025					
				40	40	Dx4.431.025					
				40	40	Dx4.131.031					
				40	50	Dx4.231.031					
				50	40	Dx4.331.031					
				50	50	Dx4.431.031					
400	77	200	277	40	40	Dx4.140.020					
				40	50	Dx4.240.020					
				50	40	Dx4.340.020					
				50	50	Dx4.440.020					
	127	250	127	40	40	Dx4.140.025					
				40	50	Dx4.240.025					
				50	40	Dx4.340.025					
				50	50	Dx4.440.025					
				40	40	Dx4.140.031					
				40	50	Dx4.240.031					
				50	40	Dx4.340.031					
				50	50	Dx4.440.031					
256	400	256	40	40	Dx4.140.040						
			40	50	Dx4.240.040						
			50	40	Dx4.340.040						
			50	50	Dx4.440.040						

L : Pin Length recommendations

The plates are torch-cut and stress relieved.  
The steel or bronze-plated steel guide elements can be chosen from our "Guide Elements" catalogue.  
The two rear pillars are offset by two mm towards the outside for foolproofing.

Delivery: 72 hours ex works

### Examples

Die set with stripper plate : D84.450.031  
Identical die set without stripper plate : D94.450.031

Ext. dimensions				C <sub>1</sub> ±1	C <sub>2</sub> ±1	C <sub>3</sub> ±1	d <sub>1</sub> /L	e <sub>1</sub>	e <sub>2</sub>	P	References x = 8 : with C3 x = 9 : without C3
Work space, direction A		Work space, direction B									
a <sub>1</sub>	b <sub>2</sub>	b <sub>1</sub>	a <sub>2</sub>								
500	106	250	356	40	40	32	32/220	410	160	45	Dx4.150.025
				40	50						Dx4.250.025
				50	40						Dx4.350.025
				50	50						Dx4.450.025
	171	315		127	40				40		Dx4.150.031
					40				50		Dx4.250.031
					50				40		Dx4.350.031
					50				50		Dx4.450.031
					40				40		Dx4.150.040
					40				50		Dx4.250.040
					50				40		Dx4.350.040
					50				50		Dx4.450.040
630	152	315	467	50	50	40	40/220	530	215	50	Dx4.163.031
				50	58						Dx4.263.031
				58	50						Dx4.363.031
				58	58						Dx4.463.031
	237	400		127	50				50		Dx4.163.040
					50				58		Dx4.263.040
					58				50		Dx4.363.040
					58				58		Dx4.463.040
					50				50		Dx4.163.050
					50				58		Dx4.263.050
					58				50		Dx4.363.050
					58				58		Dx4.463.050
710	205	400	515	50	50	40	50/250	590	280	60	Dx4.171.040
				50	58						Dx4.271.040
				63	58						Dx4.371.040
				63	63						Dx4.471.040
	305	500		127	58				58		Dx4.171.050
					58				63		Dx4.271.050
					63				58		Dx4.371.050
					63				63		Dx4.471.050
					58				58		Dx4.171.063
					58				63		Dx4.271.063
					63				58		Dx4.371.063
					63				63		Dx4.471.063

L : Pin Length recommendations



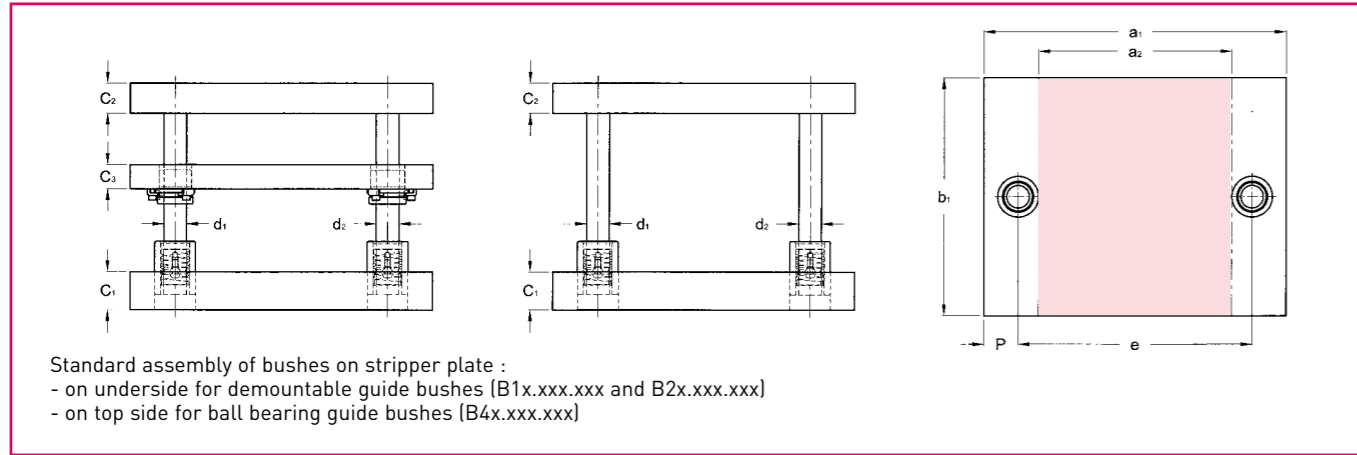

Ext. dimensions			C <sub>1</sub> ±1	C <sub>2</sub> ±1	C <sub>3</sub> ±1	d <sub>1</sub> /L	d <sub>2</sub> /L	e	P	Reference x = 8 : with C3 x = 9 : without C3	
a <sub>1</sub>	b <sub>1</sub>	a <sub>2</sub>									
Work space											
250	160	120	32	32	32	25/200	24/200	165	42,5	Dx6.125.016	
			32	40						Dx6.225.016	
			40	32						Dx6.325.016	
			40	40						Dx6.425.016	
			32	32						Dx6.125.020	
			32	40						Dx6.225.020	
	200	120	120	40						32	Dx6.325.020
				40						40	Dx6.425.020
				32						32	Dx6.125.025
				32						40	Dx6.225.025
				40						32	Dx6.325.025
				40						40	Dx6.425.025
315	200	170	32	32	32	32/200	30/200	224	45,5	Dx6.131.020	
			32	40						Dx6.231.020	
			40	32						Dx6.331.020	
			40	40						Dx6.431.020	
			32	32						Dx6.131.025	
			32	40						Dx6.231.025	
	250	170	170	40						32	Dx6.331.025
				40						40	Dx6.431.025
				40						40	Dx6.131.031
				40						50	Dx6.231.031
				50						40	Dx6.331.031
				50						50	Dx6.431.031
400	200	255	40	40	32	32/200	30/200	309	45,5	Dx6.140.020	
			40	50						Dx6.240.020	
			50	40						Dx6.340.020	
			50	50						Dx6.440.020	
			40	40						Dx6.140.025	
			40	50						Dx6.240.025	
	250	255	255	50						40	Dx6.340.025
				50						50	Dx6.440.025
				40						40	Dx6.140.031
				40						50	Dx6.240.031
				50						40	Dx6.340.031
				50						50	Dx6.440.031
315	255	255	40	40	Dx6.140.040						
			40	50	Dx6.240.040						
			50	40	Dx6.340.040						
			50	50	Dx6.440.040						
			40	40	Dx6.140.040						
			40	50	Dx6.240.040						
400	255	255	50	40	Dx6.340.040						
			50	50	Dx6.440.040						
			40	40	Dx6.140.040						
			40	50	Dx6.240.040						
			50	40	Dx6.340.040						
			50	50	Dx6.440.040						

L : Pin Length recommendations

The plates are torch-cut and stress relieved.  
 The guide elements with ball bearings (bush B30.xxx.xxx) can be chosen from our "Guide Elements" catalogue.

**Please note:** The work space is reduced if B40 or B42 bushes are used (see pages 9 and 10 - position of clamps - dimensions Q1 and Q2).

**Delivery: 72 hours ex works**

Examples	Die set with stripper plate:	D86.463.040
	Identical die set without stripper plate:	D96.463.040

Ext. dimensions a <sub>1</sub>	b <sub>1</sub>	a <sub>2</sub>	C <sub>1</sub> ±1	C <sub>2</sub> ±1	C <sub>3</sub> ±1	d <sub>1</sub> /L	d <sub>2</sub> /L	e	P	Reference x = 8 : with C3 x = 9 : without C3	
											Work space
500	250	330	40	40	32	40/220	38/220	395	52,5	Dx6.150.025	
			40	50						Dx6.250.025	
			50	40						Dx6.350.025	
			50	50						Dx6.450.025	
			40	40						Dx6.150.031	
			40	50						Dx6.250.031	
	315	330	330	50						40	Dx6.350.031
				50						50	Dx6.450.031
				40						40	Dx6.150.040
				40						50	Dx6.250.040
				50						40	Dx6.350.040
				50						50	Dx6.450.040
630	315	429	40	40	40	50/220	48/220	510	60	Dx6.150.050	
			40	50						Dx6.250.050	
			50	40						Dx6.350.050	
			50	50						Dx6.450.050	
			50	50						Dx6.163.031	
			50	58						Dx6.263.031	
	400	429	429	58						50	Dx6.363.031
				58						58	Dx6.463.031
				50						50	Dx6.163.040
				50						58	Dx6.263.040
				58						50	Dx6.363.040
				58						58	Dx6.463.040
500	429	429	50	50	Dx6.163.050						
			50	58	Dx6.263.050						
			58	50	Dx6.363.050						
			58	58	Dx6.463.050						
			50	50	Dx6.163.063						
			50	58	Dx6.263.063						
710	400	509	58	50	40	50/250	48/250	590	60	Dx6.363.063	
			58	58						Dx6.463.063	
			58	63						Dx6.171.040	
			63	58						Dx6.271.040	
			63	63						Dx6.371.040	
			63	63						Dx6.471.040	
	500	509	509	58						58	Dx6.171.050
				58						63	Dx6.271.050
				63						58	Dx6.371.050
				63						63	Dx6.471.050
				58						58	Dx6.171.063
				58						63	Dx6.271.063
630	509	509	63	58	Dx6.371.063						
			63	63	Dx6.471.063						
			58	63	Dx6.171.063						
			63	58	Dx6.271.063						
			63	63	Dx6.371.063						
			63	63	Dx6.471.063						

L : Pin Length recommendations

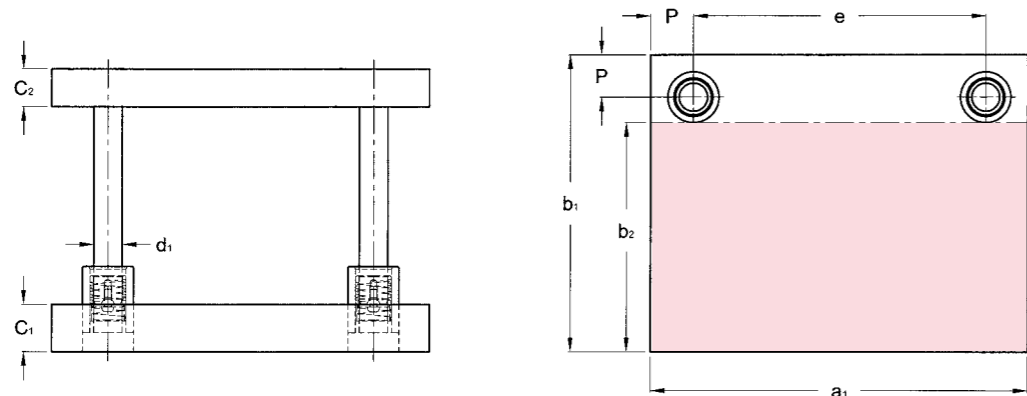

Ext. dimensions			C <sub>1</sub> ±1	C <sub>2</sub> ±1	d <sub>1</sub> /L	e	P	Reference
a <sub>1</sub>	b <sub>2</sub>	b <sub>1</sub>						
Work space								
250	93	160	32	32	32/200	170	40	D97.125.016
			32	40				D97.225.016
			40	32				D97.325.016
			40	40				D97.425.016
	133	200	32	32				D97.125.020
			32	40				D97.225.020
			40	32				D97.325.020
			40	40				D97.425.020
	183	250	32	32				D97.125.025
			32	40				D97.225.025
			40	32				D97.325.025
			40	40				D97.425.025
315	128	200	32	32	32/200	225	45	D97.131.020
			32	40				D97.231.020
			40	32				D97.331.020
			40	40				D97.431.020
	178	250	32	32				D97.131.025
			32	40				D97.231.025
			40	32				D97.331.025
			40	40				D97.431.025
	243	315	40	40				D97.131.031
			40	50				D97.231.031
			50	40				D97.331.031
			50	50				D97.431.031
400	128	200	40	40	32/220	310	45	D97.140.020
			40	50				D97.240.020
			50	40				D97.340.020
			50	50				D97.440.020
	178	250	40	40				D97.140.025
			40	50				D97.240.025
			50	40				D97.340.025
			50	50				D97.440.025
	230	315	40	40				D97.140.031
			40	50				D97.240.031
			50	40				D97.340.031
			50	50				D97.440.031
315	400	40	40	D97.140.040				
		40	50	D97.240.040				
		50	40	D97.340.040				
		50	50	D97.440.040				

L : Pin Length recommendations

The plates are torch-cut and stress relieved.  
The guide elements with ball bearings (bush B30.xxx.xxx) can be chosen from our "Guide Elements" catalogue.

**Please note:** The work space is reduced if B40 bushes are used  
(see pages 9 - position of clamps - dimensions Q1 and Q2).

**Delivery: 72 hours ex works**

**Example** Rectangular stock die set with rear ball bearing guides: **D97.350.040**

Ext. dimensions			C <sub>1</sub> ±1	C <sub>2</sub> ±1	d <sub>1</sub> /L	e	P	Reference
a <sub>1</sub>	b <sub>2</sub>	b <sub>1</sub>						
Work space								
500	157	250	40	40	40/220	395	52,5	D97.150.025
			40	50				D97.250.025
			50	40				D97.350.025
			50	50				D97.450.025
	222	315	40	40				D97.150.031
			40	50				D97.250.031
			50	40				D97.350.031
			50	50				D97.450.031
	307	400	40	40				D97.150.040
			40	50				D97.250.040
			50	40				D97.350.040
			50	50				D97.450.040
407	500	40	40	D97.150.050				
		40	50	D97.250.050				
		50	40	D97.350.050				
		50	50	D97.450.050				
630	206	315	50	50	50/220	510	60	D97.163.031
			50	58				D97.263.031
			58	50				D97.363.031
			58	58				D97.463.031
	291	400	50	50				D97.163.040
			50	58				D97.263.040
			58	50				D97.363.040
			58	58				D97.463.040
	391	500	50	50				D97.163.050
			50	58				D97.263.050
			58	50				D97.363.050
			58	58				D97.463.050
521	630	50	50	D97.163.063				
		50	58	D97.263.063				
		58	50	D97.363.063				
		58	58	D97.463.063				
710	291	400	58	58	50/250	590	60	D97.171.040
			58	63				D97.271.040
			63	58				D97.371.040
			63	63				D97.471.040
	391	500	58	58				D97.171.050
			58	63				D97.271.050
			63	58				D97.371.050
			63	63				D97.471.050
	521	630	58	58				D97.171.063
			58	63				D97.271.063
			63	58				D97.371.063
			63	63				D97.471.063

L : Pin Length recommendations

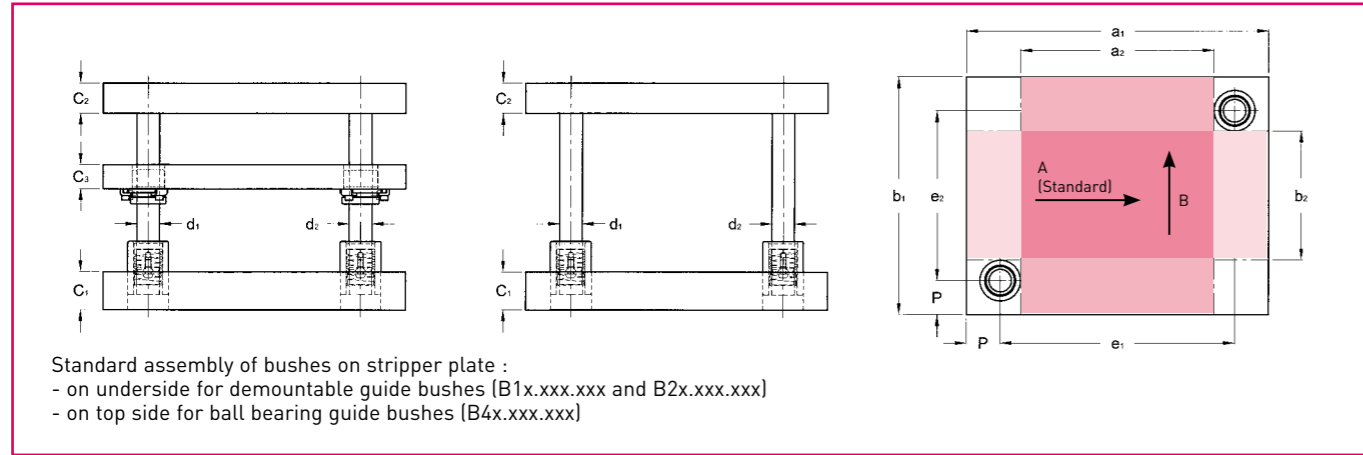

Ext. dimensions				C <sub>1</sub> ±1	C <sub>2</sub> ±1	C <sub>3</sub> ±1	d <sub>1</sub> /L	d <sub>2</sub> /L	e <sub>1</sub>	e <sub>2</sub>	P	Reference x = 8 : with C3 x = 9 : without C3								
Work space, direction A		Work space, direction B																		
a <sub>1</sub>	b <sub>2</sub>	b <sub>1</sub>	a <sub>2</sub>																	
250	30	160	120	32	32	32	25/200	24/200	165	75	42,5	Dx8.125.016 Dx8.225.016 Dx8.325.016 Dx8.425.016								
				40	40								50	145	52,5					
				32	32											32	200	120	Dx8.125.020 Dx8.225.020 Dx8.325.020 Dx8.425.020	
				40	40															250
	32	32	32	200	120					Dx8.131.020 Dx8.231.020 Dx8.331.020 Dx8.431.020										
	40	40											250	171						
	32	32														32	250	171	Dx8.131.031 Dx8.231.031 Dx8.331.031 Dx8.431.031	
	40	40																		315
	40	40	315	260	Dx8.140.025 Dx8.240.025 Dx8.340.025 Dx8.440.025															
	50	40								400			260	Dx8.140.031 Dx8.240.031 Dx8.340.031 Dx8.440.031						
	50	50														400	260	Dx8.140.040 Dx8.240.040 Dx8.340.040 Dx8.440.040		
	50	50																	400	260

L : Pin Length recommendations

The plates are torch-cut and stress relieved.  
The guide elements with ball bearings (bush B30.xxx.xxx) can be chosen from our "Guide Elements" catalogue.

**Please note:** The work space is reduced if B40 bushes are used (see page 9 and 10 - position of clamps - dimensions Q1 and Q2).

**Delivery: 72 hours ex works**

### Examples

Die set with stripper plate: D88.125.016  
Identical die set without stripper plate: D98.125.016

Ext. dimensions				C <sub>1</sub> ±1	C <sub>2</sub> ±1	C <sub>3</sub> ±1	d <sub>1</sub> /L	d <sub>2</sub> /L	e <sub>1</sub>	e <sub>2</sub>	P	Reference x = 8 : with C3 x = 9 : without C3												
Work space, direction A		Work space, direction B																						
a <sub>1</sub>	b <sub>2</sub>	b <sub>1</sub>	a <sub>2</sub>																					
500	80	250	330	40	40	32	40/220	38/220	395	145	52,5	Dx8.150.025 Dx8.250.025 Dx8.350.025 Dx8.450.025												
				40	40								210	52,5										
				40	40										230	400	120	Dx8.150.031 Dx8.250.031 Dx8.350.031 Dx8.450.031						
				50	50														250	400	171	Dx8.150.040 Dx8.250.040 Dx8.350.040 Dx8.450.040		
	40	40	330	500	250					171													Dx8.150.050 Dx8.250.050 Dx8.350.050 Dx8.450.050	
	40	40											330											500
	50	50													400	400	200	171						
	50	50																	400	400	200	171		
	50	50	400	400	200					171													Dx8.163.063 Dx8.263.063 Dx8.363.063 Dx8.463.063	
	50	50											400											400
	50	50													400	400	200	171						
	50	50																	400	400	200	171		

L : Pin Length recommendations

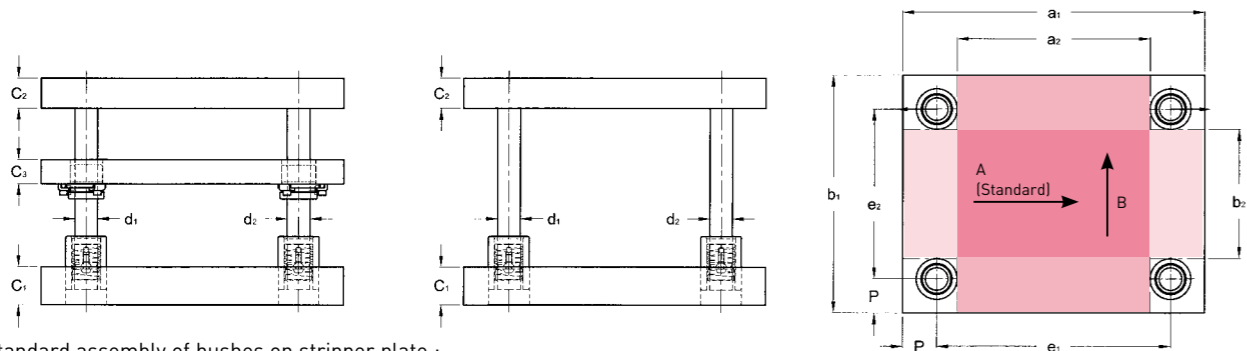

Standard assembly of bushes on stripper plate :  
 - on underside for demountable guide bushes (B1x.xxx.xxx and B2x.xxx.xxx)  
 - on top side for ball bearing guide bushes (B4x.xxx.xxx)

Ext. dimensions				C <sub>1</sub> ±1	C <sub>2</sub> ±1	C <sub>3</sub> ±1	d <sub>1</sub> /L	e <sub>1</sub>	e <sub>2</sub>	P	Reference x = 8 : with C3 x = 9 : without C3
Work space, direction A		Work space, direction B									
a <sub>1</sub>	b <sub>2</sub>	b <sub>1</sub>	a <sub>2</sub>								
250	30	160	120	32	32	32	25/200	165	75	42,5	Dx9.125.016
				32	40						Dx9.225.016
				40	32						Dx9.325.016
				40	40						Dx9.425.016
	70	200	120	32	32				Dx9.125.020		
				32	40				Dx9.225.020		
				40	32				Dx9.325.020		
				40	40				Dx9.425.020		
	120	250	120	32	32				Dx9.125.025		
				32	40				Dx9.225.025		
				40	32				Dx9.325.025		
				40	40				Dx9.425.025		
315	70	200	185	32	32	32	25/200	230	115	42,5	Dx9.131.020
				32	40						Dx9.231.020
				40	32						Dx9.331.020
				40	40						Dx9.431.020
	120	250	185	32	32				Dx9.131.025		
				32	40				Dx9.231.025		
				40	32				Dx9.331.025		
				40	40				Dx9.431.025		
	185	315	185	40	40				Dx9.131.031		
				40	50				Dx9.231.031		
				50	40				Dx9.331.031		
				50	50				Dx9.431.031		
400	70	200	270	40	40	32	25/200	315	115	42,5	Dx9.140.020
				40	50						Dx9.240.020
				50	40						Dx9.340.020
				50	50						Dx9.440.020
	120	250	270	40	40				Dx9.140.025		
				40	50				Dx9.240.025		
				50	40				Dx9.340.025		
				50	50				Dx9.440.025		
	165	315	250	40	40				Dx9.140.031		
				40	50				Dx9.240.031		
				50	40				Dx9.340.031		
				50	50				Dx9.440.031		
250	400	250	40	40	Dx9.140.040						
			40	50	Dx9.240.040						
			50	40	Dx9.340.040						
			50	50	Dx9.440.040						

L : Pin Length recommendations

The plates are torch-cut and stress relieved.  
 The guide elements with ball bearings (bush B30.xxx.xxx) can be chosen from our "Guide Elements" catalogue.

**Please note:** The work space is reduced if B40 bushes are used  
 (see pages 9 and 10 - position of clamps - dimensions Q1 and Q2).

**Delivery: 72 hours ex works**

#### Examples

Die set with stripper plate: D89.125.016  
 Identical die set without stripper plate: D99.125.016

Ext. dimensions				C <sub>1</sub> ±1	C <sub>2</sub> ±1	C <sub>3</sub> ±1	d <sub>1</sub> /L	e <sub>1</sub>	e <sub>2</sub>	P	Reference x = 8 : with C3 x = 9 : without C3
Work space, direction A		Work space, direction B									
a <sub>1</sub>	b <sub>2</sub>	b <sub>1</sub>	a <sub>2</sub>								
500	100	250	350	40	40	32	32/220	404	154	48	Dx9.150.025
				40	50						Dx9.250.025
				50	40						Dx9.350.025
				50	50						Dx9.450.025
	165	315		350	40				40		Dx9.150.031
					40				50		Dx9.250.031
					50				40		Dx9.350.031
					50				50		Dx9.450.031
	250	400		350	40				40		Dx9.150.040
					40				50		Dx9.250.040
					50				40		Dx9.350.040
					50				50		Dx9.450.040
350	500	350	40	40	Dx9.150.050						
			40	50	Dx9.250.050						
			50	40	Dx9.350.050						
			50	50	Dx9.450.050						
630	140	315	455	50	50	40	40/220 520	520	205	55	Dx9.163.031
				50	58						Dx9.263.031
				58	50						Dx9.363.031
				58	58						Dx9.463.031
	225	400		455	50				50		Dx9.163.040
					50				58		Dx9.263.040
					58				50		Dx9.363.040
					58				58		Dx9.463.040
	325	500		455	50				50		Dx9.163.050
					50				58		Dx9.263.050
					58				50		Dx9.363.050
					58				58		Dx9.463.050
455	630	455	50	50	Dx9.163.063						
			50	58	Dx9.263.063						
			58	50	Dx9.363.063						
			58	58	Dx9.463.063						
710	190	400	500	58	58	40	50/250	581	271	64,5	Dx9.171.040
				58	63						Dx9.271.040
				63	58						Dx9.371.040
				63	63						Dx9.471.040
	290	500		500	58				58		Dx9.171.050
					58				63		Dx9.271.050
					63				58		Dx9.371.050
					63				63		Dx9.471.050
	420	630		500	58				58		Dx9.171.063
					58				63		Dx9.271.063
					63				58		Dx9.371.063
					63				63		Dx9.471.063

L : Pin Length recommendations



## **DIE SETS - MACHINED PLATES ACCORDING TO DRAWING CONTENTS**

■ Machine capacities .....	<b>24</b>
■ Special die sets .....	<b>25</b>
■ MDL geometric standards .....	<b>26</b>
■ Dimensioning instructions for special rectangular die sets .....	<b>27</b>
■ Machined plates .....	<b>28</b>
■ The KIT - Die Sets .....	<b>29</b>

We perform machining on CNC machines.

**CNC TORCH CUTTING** Max. L x W x thickness: 6,000 x 2,300 x 250 mm  
Tolerance to ± 2 mm

**STRESS RELIEVING** L x W x H max.: 4,500 x 2,300 x 1,600 mm  
Max. load: 20 T

## MACHINING

**Grinding:** Blancard and tangential-type. Max.load: 2T  
Max. diagonal: 2,200 mm

**Milling on machining centre**  
Max. stroke (X) : X x Y x Z: 3,650 x 1,750 x 710 mm Max. load: 9 T  
Max. stroke (Y and Z) : X x Y x Z: 3,000 x 2,500 x 1,000 mm Max. load: 6 T  
Large capacity : X x Y x Z: 4,010 x 2,500 x 670 mm Max. load: 15 T

**Deep drilling**  
Max. stroke : X x Y x Z: 2,000 x 1,000 x 1,500 mm Max. load: 15 T

**Boring, Drilling, Edge milling, etc.**

**MECHANICAL WELDING** can be carried out upon demand

**HANDLING**  
Bridge cranes of up to 20 T

## STEEL PLATE SPECIFICATIONS

**In stock:** C25 - C45  
**Upon demand:** Pre-treated steel, high-strength aluminium, etc.  
Stress relieving upon request.

## TYPES OF PLATES

The peripheral shapes are torch-cut and deburred. The edges may be milled for reference surfaces.  
**If tolerances are not specified for the thickness, the plates will be spotfaced to the minimum extent**, i.e. the blank sheet of the specified thickness is ground until our standards of flatness and parallel alignment are obtained  
Spot facing = 0 to 3 mm/metre max.

## DIE SETS WITH TORCH-CUTTING AND MACHINING ACCORDING TO DRAWING

We manufacture die sets according to your drawing and design specifications. Heavy machining removing a lot of metal, carried out after the die set has been assembled, may cause deformations. We recommend that you let us perform these machining operations.

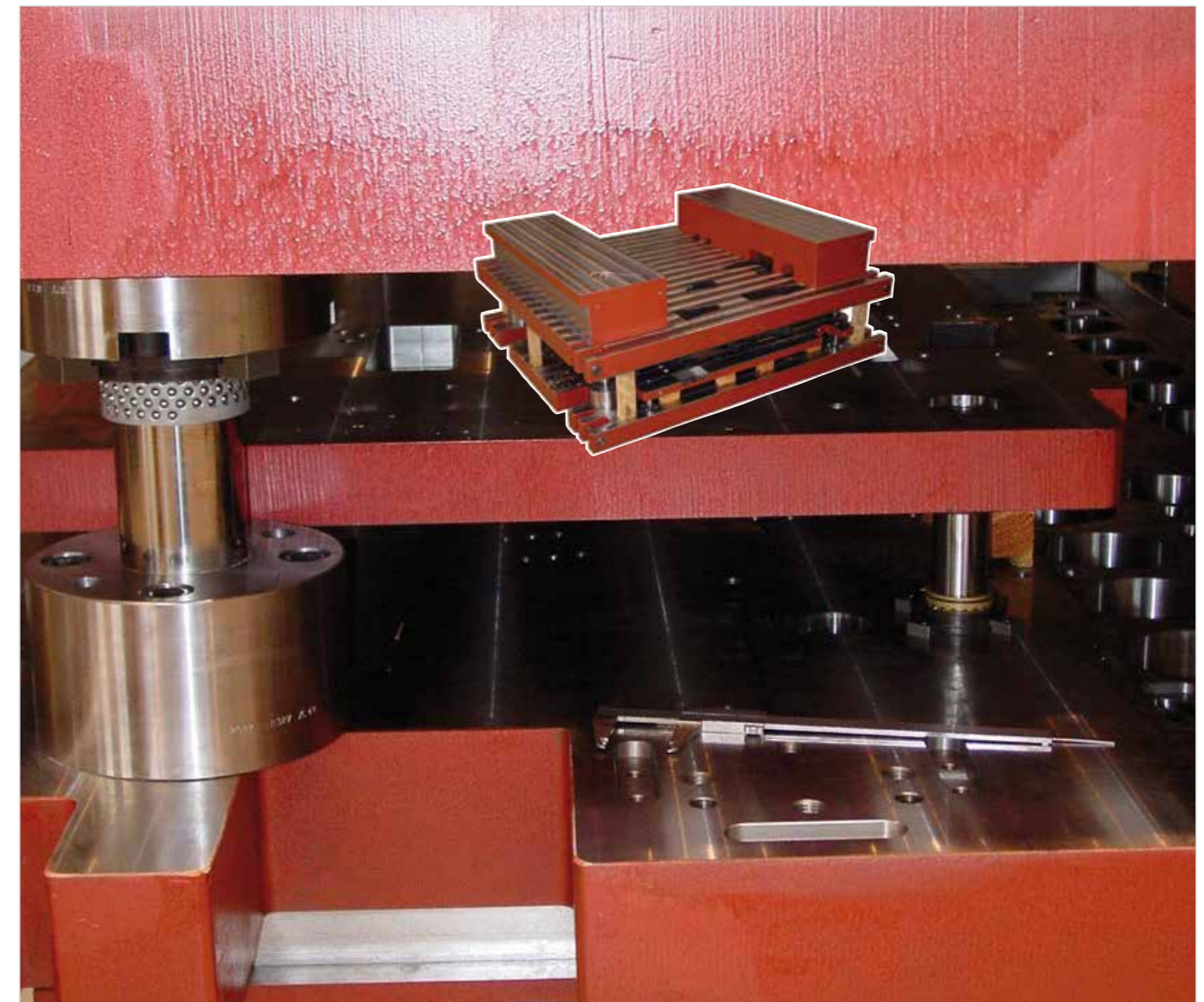

FLATNESS OF PLATE FACES	
Thickness	TE
E > 30mm	0,004 / 100 mm
20 < E < 30 mm	0,008 / 100 mm

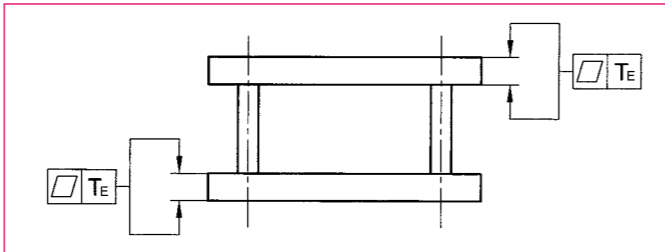

PARALLEL ALIGNMENT OF PLATE FACES		
from mm	to mm	TP
0	100	0,006
100	200	0,012
200	300	0,018

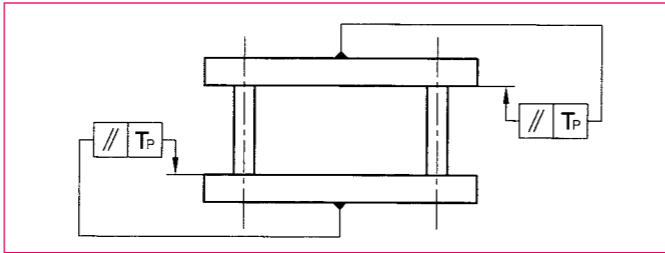

PARALLEL ALIGNMENT OF EXTERNAL FACES OF DIE SET		
from mm	to mm	TP
0	100	0,008
100	200	0,012
200	300	0,018
300	400	0,024
400	500	0,030
500	600	0,036

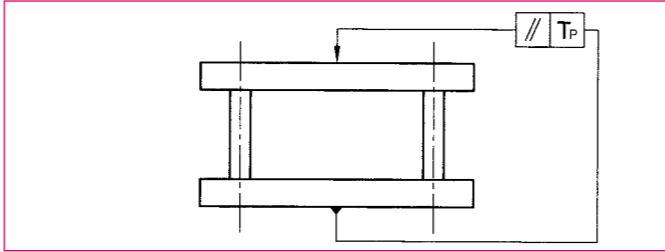

LOCATION
TA: ±12 µm/m + additional 5 µm/m

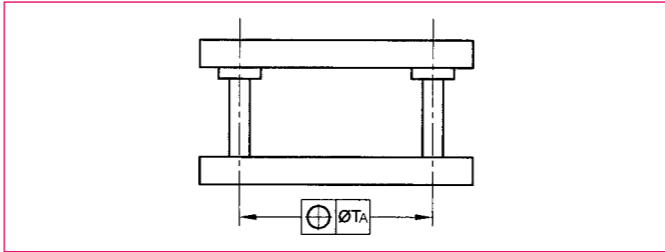

PERPENDICULARITY
TW
0,015 / 100mm

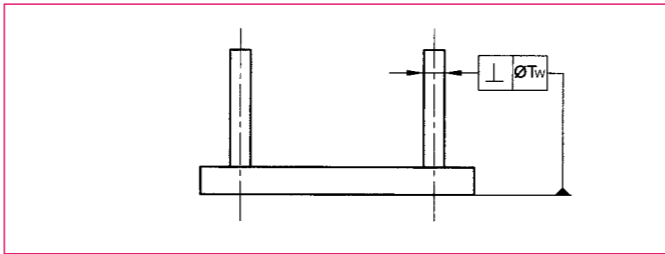

ADJUSTMENT OF BORES	
Guide pillar	Guide bush
d = R6	D = H6

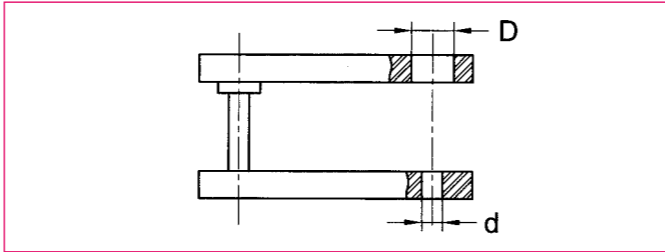
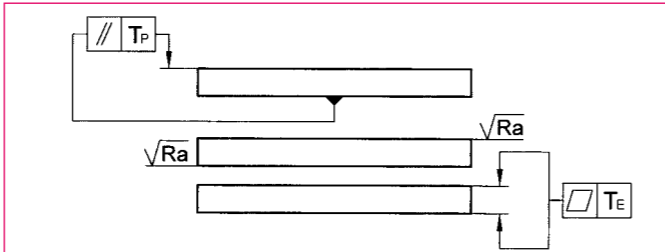
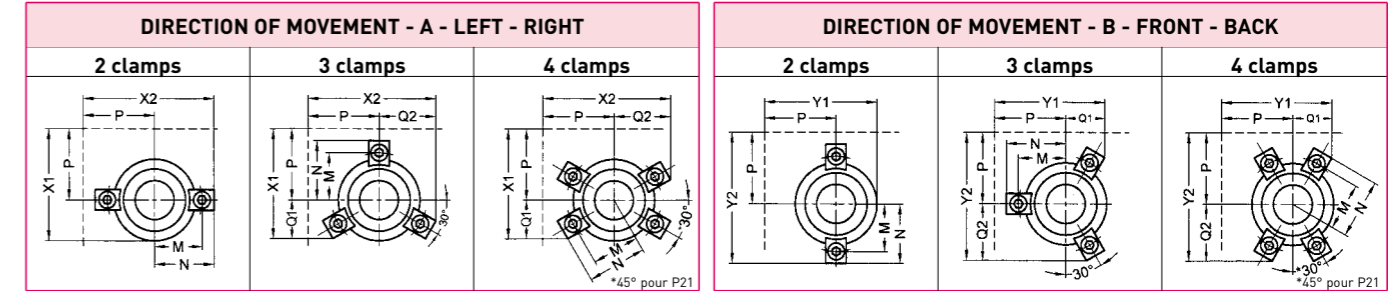

PLATE WITH MIN. SPOTFACING		
TE	TP	RA
0,04/1000 mm	0,06/1000 mm	3,2



RECOMMENDED PILLAR DIAMETER ACCORDING TO LENGTH A1 OF PLATE						
Length a1	150 - 300	350 - 500	550 - 700	750 - 1000	1100 - 1900	2000 - 2500
Recommended d1	25	32	40	50	63	80



STANDARD POSITION OF GUIDES AND FIXINGS							
		GUIDE PILLAR		P10 - P21 - P22			
Diameter	19 - 20	24 - 25	30 - 32	38 - 40	48 - 50	63	80
no. of P21 clamps	3 x M5	3 x M6	3 x M6	4 x M8	4 x M8	4 x M8	4 x M8
		GUIDE BUSH		B10 - B20			
P	30	40	45	50	60	65	75
X1 / Y1	46,3	64,2	71	81,5	97,5	111,5	132,5
X2 / Y2	55,5	74	82	94,1	112,3	122	141,6
no. of clamps	2 x M5	3 x M6	3 x M6	4 x M8	4 x M8	4 x M8	4 x M8
		GUIDE BUSH		B12 - B22			
P	30	40	45	50	60	65	75
X1 / Y1	46,3	65,3	72	83,8	97,5	102,5	132,5
X2 / Y2	55,5	76,6	84,6	99	114,2	127,5	146,6
no. of clamps	2 x M5	3 x M6	3 x M6	4 x M8	4 x M8	4 x M8	4 x M8
		BALL BEARING GUIDE BUSH		B30 - B40			
P	-	45	50	55	65	70	80
X1 / Y1	-	71	81,5	92,5	111,5	124	142,5
X2 / Y2	-	82	94,1	104,3	122	134	151,8
no. of B40 clamps	-	3 x M6	3 x M8	4 x M8	4 x M8	4 x M8	4 x M8
		BALL BEARING GUIDE BUSH intermediate plate		B42			
P	-	45	50	55	65	-	-
X1 / Y1	-	72	79,3	92,5	111,5	-	-
X2 / Y2	-	84,6	93,5	103,7	121,5	-	-
no. of clamps	-	3 x M6	3 x M6	4 x M6	4 x M6	-	-

RECOMMENDED PLATE THICKNESS ACCORDING TO TYPE OF GUIDE ELEMENT USED									
Diameter	P10	P21	P22	B10-B20	B12-B22	B30	B40	B42	Plates
19 - 20	25	25	38	-	-	-	-	-	C1
	20	20	30	20	20	-	-	-	C2
	-	-	-	20	20	-	-	-	C3
24 - 25	32	32	46	-	-	32	32	-	C1
	25	25	38	25	25	32	32	-	C2
	-	-	-	25	25	-	-	22	C3
30 - 32	40	40	56	-	-	40	40	-	C1
	32	32	48	28	32	40	40	-	C2
	-	-	-	25	28	-	-	22	C3
38 - 40	50	50	66	-	-	50	50	-	C1
	40	40	58	32	40	50	50	-	C2
	-	-	-	32	50	-	-	32	C3
48 - 50	58	58	76	-	-	58	58	-	C1
	50	50	68	38	50	58	58	-	C2
	-	-	-	32	50	-	-	38	C3
63	63	63	86	-	-	63	63	-	C1
	58	58	78	50	63	63	63	-	C2
	-	-	-	40	63	-	-	-	C3
80	68	68	98	-	-	-	-	-	C1
	60	60	92	50	80	-	-	-	C2
	-	-	-	40	80	-	-	-	C3

### STEEL PLATE SPECIFICATIONS

**In stock:** C25 - C45  
**Upon demand:** Pre-treated steel, high-strength aluminium, etc.  
 Stress relieving upon request.

### TYPES OF PLATES:

The peripheral shapes are torch-cut and deburred. The edges can be milled for reference surfaces.  
**If tolerances are not specified for the thickness, the plates will be spotfaced to the minimum extent**, i.e. the blank sheet of the specified thickness is ground until our standards of flatness and parallel alignment are obtained  
 Spot facing = Max. of 0 to 3 mm/metre

### PLATES WITH TORCH CUTTING AND SPECIAL MACHINING

We can torch-cut, grind and machine **plates according to your drawings**. All of our plates are annealed. If these machining operations require the removal of large amounts of material, it is in your interest to let us perform the roughing (see finish). We control the risks of deformations due to internal stresses.

### PLATES WITH TORCH CUTTING AND SPECIAL MACHINING - Other thicknesses available upon request.

C25 : 12 - 15 - 20 - 25 - 30 - 35 - 40 - 42 - 45 - 50 - 52 - 55 - 60 - 65 - 70 - 75 - 80 - 85 - 90 - 95 - 100 - 105 - 110 - 120 - 150  
 C45 : 15 - 20 - 25 - 30 - 35 - 40 - 45 - 50 - 55 - 60 - 65 - 70 - 80 - 85 - 90 - 95 - 100 - 105 - 110 - 120 - 130 - 140 - 160

### FOR YOUR PLATE ORDERS

Please specify: :

- Steel grade of the plate
- Number of plates
- External dimensions
- Spotfaced or toleranced faces
- Torch-cut or milled edges
- **Special machining operations with detailed drawing**



### NEW - THE KIT

#### PLATE (S)

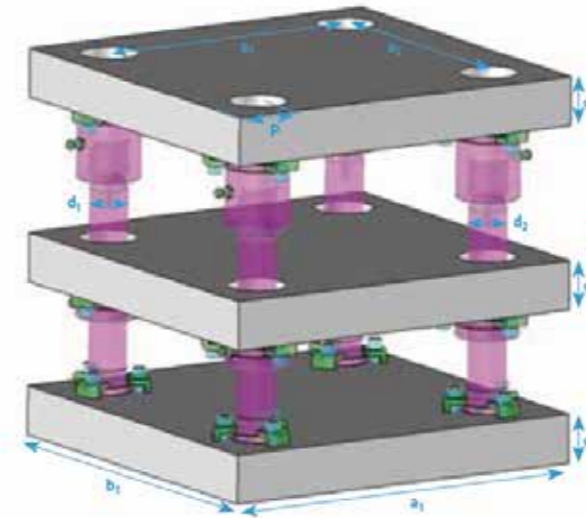

#### GUIDING ELEMENTS



Example of possible arrangement of the KIT, configuration and options

The KIT is of machined plates according to customer specifications and delivered with MDL Standard guiding components.

- Plates are in C25 Steel, flamse cut and stress relieved.
- Plates are segment surface grinded.
- Guiding elements are from our catalogs (from MDL standard, DIN, or AFNOR) , and are delivered not-assembled with the plates.
- Machining tolerances (mm / lm) :

	0,06		0,04	Ra	<3,2		+/-0,2		+/-2
--	------	--	------	----	------	--	--------	--	------

- Delivery time : 72 hours EXW

- **Options :**
  - Bore machining for Pillar/Bushes
  - Reference surface machining
  - Lifting holes
  - Flame cut areas according to drawings

### Example

Die Sets (incl C3) Le KIT with 4 guiding elements (to be detailed with the related order document).  
 DI16K – Die Sets – The KIT.

Dim. Externes	C123 + 1	D <sub>1</sub>	D <sub>2</sub>	e <sub>1</sub>	e <sub>2</sub>	P	REFERENCES
diagonal max = 2200 mm	150 mm max						
a <sub>1</sub> et b <sub>1</sub> to be detailed with the order	to be detailed with the order	according to your guiding element spec.		Options to be detailed with the order			<b>DI16K</b> Options to be detailed with the order



**MDL****MDL GROUP**  
**www.mdl-eu.com****EUROPE**

MDL Europe - MDL Rodis SAS  
Aire d'activité du Florival  
9 rue de l'Oberwald  
FR-68500 ISSENHEIM  
Tél : +33 (0)3 89 74 24 24  
mdl@mdl-rodiss.com

MDL PORTER BESSON SAS  
Zone Eurespace  
5 rue Nosières  
FR-25770 SERRE LES SAPINS  
Tél : +33 (0)3 81 58 95 00  
porter-besson@mdl-rodiss.com

MDL Deutschland GmbH  
Munzinger Strasse 1  
DE-79111 FREIBURG IM BREISGAU  
Tel. +49(0)761 503 127 11  
mdl-verkauf@mdl-rodiss.com

**BRAZIL**

MDL - Maquinas Danly Ltda  
Av. Prink 151  
BR-CEP 18120 MAIRINQUE  
Tel.+55 11 2107 0400  
vendas@mdl-brasil.com.br  
mdl-brasil.com.br

**MEXICO**

MDL DE MEXICO SA DE CV  
Conjunto Victoria II  
Acceso III N°52 Bodega 19  
Zona Industrial Benito Juarez  
MX-CEP 76120 QUERETARO  
ventas@mdlmexico.com.mx  
www.mdlmexico.com.mx

**U.S.A.**

Mold & Die Components Inc.  
4572 N.Long Road  
USA- COLUMBUS, IN 47203  
Tel. +1 812 373-0021  
sales@mdlcomponents.com  
www.mdlcomponents.com

**INDIA**

MDL Vishal India Pvt Ltd  
S.F.N°2/2, Panapatti,  
Chettipalayam (Via), Palladam Road  
IN- COIMBATORE 641201, Tamil Nadu  
Tel : +91 (0) 42 5920 0100  
sales@mdl-india.com

**3D available on**  
[www.mdl-embedded.qa.partcommunity.com](http://www.mdl-embedded.qa.partcommunity.com)

